

# WESTMINSTER ROW

8980 WESTMINSTER BLVD, WESTMINSTER, CO

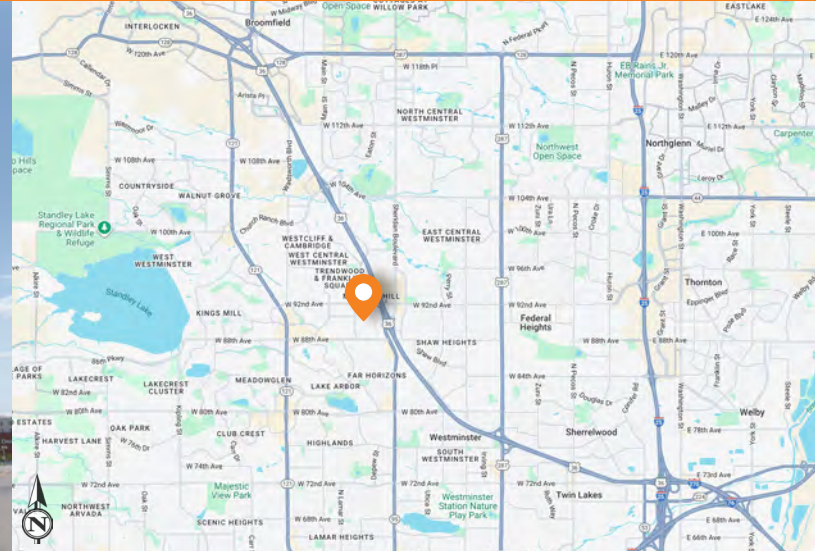

RETAIL FOR LEASE



**AVAILABLE**

Retail spaces  
1,395 SF - 4,536 SF

## PROPERTY HIGHLIGHTS

- HVAC, grease trap, and electrical ready for Restaurant use!
- Great patio opportunity - kitty corner to Center Park!
- Surface Parking adjacent - 4 hours free!
- Aerostat Park now open! Year round activities!

## NEARBY RETAILERS



**ROBIN NICHOLSON**  
303.577.9971  
robin.nicholson@dhlb.com

## TRAFFIC COUNTS

On 88th Ave east of Pierce St	24,715 CPD
On Hwy 36 north of 88th Ave	99,491 CPD
On Hwy 36 south of 88th Ave	129,922 CPD

Source: CDOT 2026

## DEMOGRAPHICS

	1 MILE	3 MILE	5 MILE
POPULATION	17,742	139,392	323,810
AVERAGE HH INCOME	\$111,676	\$118,991	\$122,087
BUSINESSES	812	5,129	16,099
EMPLOYEES	7,476	40,103	145,119

Source: Applied Geographic Solutions, 2026 Estimates



# WESTMINSTER ROW

8980 WESTMINSTER BLVD, WESTMINSTER, CO





5750 DTC Parkway, Suite 200  
Greenwood Village, CO 80111

[www.dhlb.com](http://www.dhlb.com)

**ROBIN NICHOLSON**

303.577.9971

[robin.nicholson@dhlb.com](mailto:robin.nicholson@dhlb.com)

[CLICK HERE FOR  
BROKER DISCLOSURE](#)